

ETF75 – 750 Kgs Electric Lift Table.

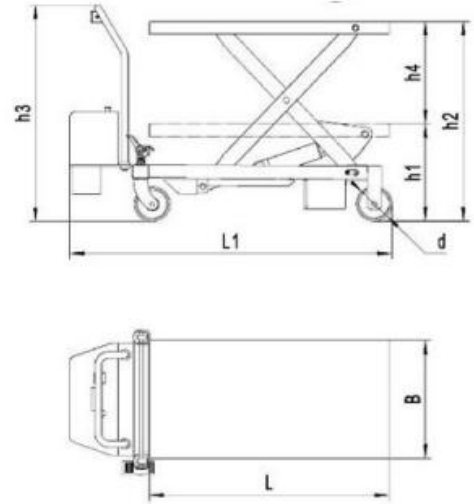

Capacity	Kg	750
Max. Table Height – h2 / Min. Table Height -h1	mm	970 / 420
Dimension of Table Size – L*B	mm	1000x510x55
Caster Wheel -d	mm	Ø147x50
Overall Length – L1	mm	1345
Height of Handle from Ground – h3	mm	935
Lifting Speed with Load / without Load	mm/s	70/80
Lowering Speed with Load / without Load	mm/s	50/35
Lifting Cycle (Fully Charged)		100
Battery x2		12v 24Ah
Vertical Travel – h4	mm	550
Lifting Motor (DC24V KW)		0.8
Charger (built-in) 24V4A		8.5Hr
Approx. Lifting Speed	s	10
Net Weight	Kg	160